

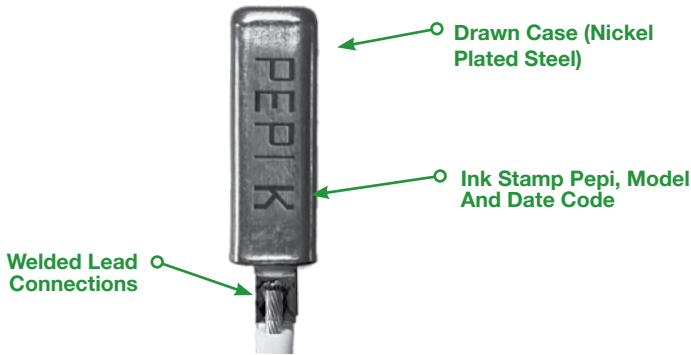

For applications requiring extra current sensitivity and reliability.

# MODEL K SERIES

The PEPI® Models K and KR creep action thermal protectors use bimetal elements with higher resistivity to increase their current sensitivity making them especially useful on low voltage / low current applications. The drawn case fits snugly into the tightest spaces without sacrificing performance reliability. Oversized, gold-diffused, fine silver contacts make the PEPI® Model K Series thermal protectors a durable, high-reliability choice for many low current applications. The Model KH uses a different bimetallic element to bring the same reliability to higher voltage applications.

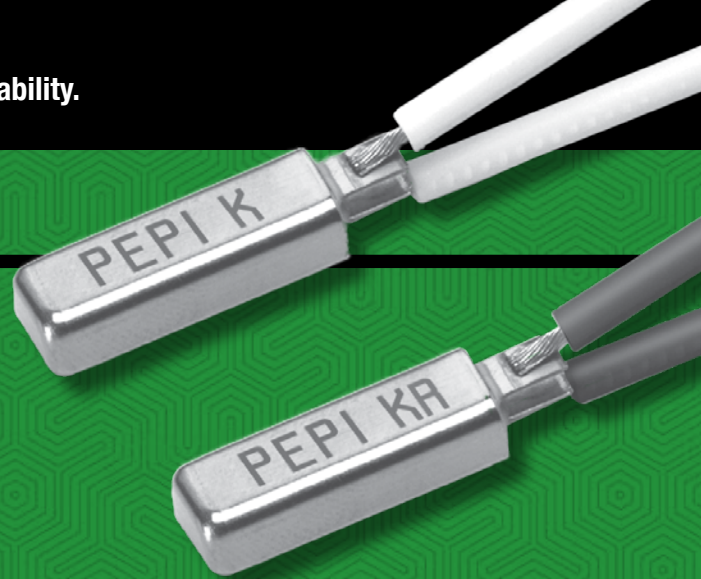

- Optional Form-Fitting Insulation Sleeve
- Customer Specified Lead Length And Insulating Material
- Calibration Dimple

**Model K and -K units** are normally in the closed position allowing electricity to flow through the circuit. When the temperature exceeds a preset high limit, the bimetal element open to break the circuit. When the temperature cools, the bimetallic element returns to its original shape closing the circuit.

**The Model KR** operates in the open position and closes the circuit upon temperature rise.

Feature	Benefit
Drawn case has small footprint	Fits neatly in tight spaces.
Different standard bimetallic elements	Offers greater versatility to meet a wider range of low to high voltage / current applications.
Case electrically live	Dissipates heat so that bimetallic element only reacts to changes in circuit load.
Conductive bimetal construction	Bimetallic element carries the circuit current.
Creep action	Slow make / slow break switching action maintains narrow differential between opening and closing temperatures.
Over-sized gold plated contacts	Maximizes current sensitivity and performance reliability.
Preset calibration temperatures	Maximizes accuracy. Calibration cannot be reset in field.

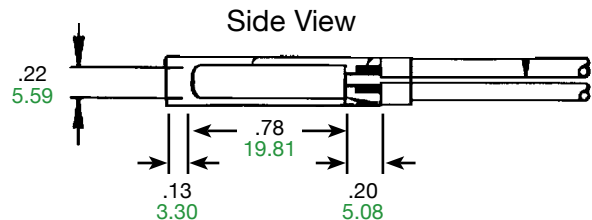
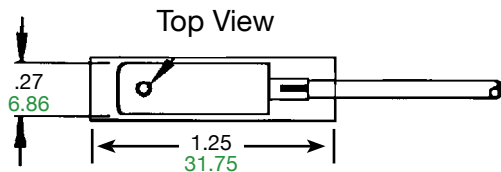

METRIC DIMENSIONS ARE IN MM (SHOWN IN GREEN)

*We come through when the heat is on®*

# MODEL K SERIES

Customization Options	Effect
Change bimetallic elements	Increase or decrease sensitivity to current.
Add lead wires	Speed production at your facility. Choose wire and insulation material best suited to your application.
Select calibration temperature	Match application needs.
Add sleeves to case	Protect device from environmental concerns or severe ambient temperatures that might influence operation.

**Model K, -K and -KH:** Install in the closed position and breaks the circuit upon temperature rise.

**Model KR:** Installs in the open position and closes the circuit upon temperature rise.

**Model -K and -KH:** Have fine silver contacts and different bimetallic element for higher voltage/ higher current applications.

## UL Recognitions (Visit [www.pepiusa.info/ul-recognitions](http://www.pepiusa.info/ul-recognitions) for full details)

**File: E37151 - Temperature Indicating and Regulating Equipment**

- Temperature Limiting or Limiting and Regulating Equipment
- Temperature Regulating Applications

**File: E42562 - Motor Protective Devices, Inherent Overheating**

## CSA Certifications (Visit [www.pepiusa.info/csa-certifications](http://www.pepiusa.info/csa-certifications) for full details)

**Class: 4823 02 Appliance Controls**

**Class: 4823 03 Motor Protectors**

Contact Ratings	Calibration Temperature Range	
4 amps / 120 VAC (resistive)	Nominal Calibration Temperatures	40°C - 150°C
4 amps / 120 VAC (inductive)	-KH	80°C - 200°C
	Reset temperature	Typically 1°-2°C lower than opening temperature

*\*Please consult our Sales Engineers for suggested contact ratings when applied to DC type loads*

# MODEL K SERIES

PEPI® MODEL K SERIES REAL WORLD PERFORMANCE

## MODEL K SERIES DERATING CURVE

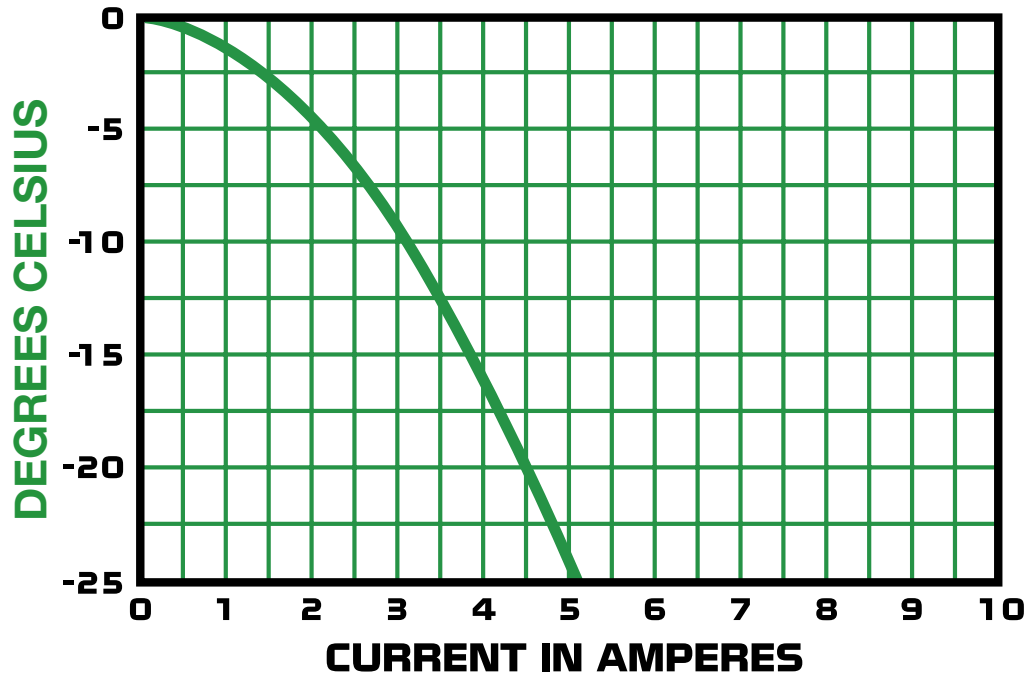

These are only representative curves based on controlled laboratory testing. Results may vary in actual applications.

## Portage Electric Products, Inc. (PEPI) The Thermal Control Specialists

This sheet contains basic technical and operating characteristic data for our Model K Series Thermal Controls.

Should you have any questions regarding the use of this device in your application, please feel free to contact us for additional technical information or assistance.

Since 1963 PEPI has been world-wide supplier of bimetallic thermostats and thermal protectors. Today, we produce almost every type of creep-action and snap-action device used in a wide range of OEM applications

